



■ Features:

- Various high power, High saturation, Low resistance
- SPC0402 used ceramic base with gold-plating
- The others used LCP plastic base

■ Applications:

- DC to DC converters for notebook, VGA card, PDA
- Other various electronic appliances

■ Parts code:

**SPC**

FLIC No.

**0810 / (3340)**

Dimensions: mm / in

**100**

Inductance code

**M**

Tolerance: K : ± 10%

■ Outline Dimension:

■ Recommended Land Pattern:

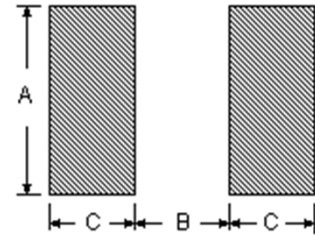
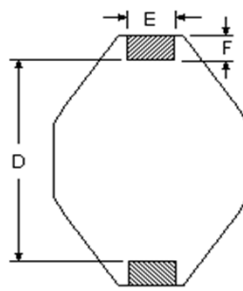
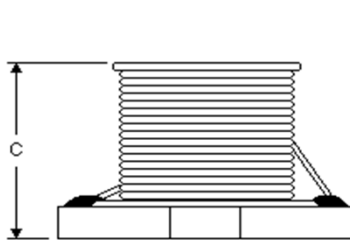
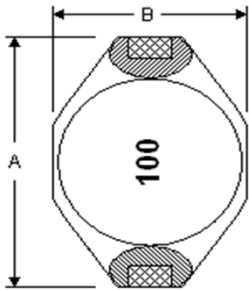

Dimensions in mm

TYPE	A	B	C	D	E	F	a	b	c
SPC 0810	12.95 Max	9.40 Max	11.43 Max	7.62	2.54	2.54	2.79 Typ	7.37 Typ	2.92 Typ

■ Specifications

SPC 0810 (3340)					
Flic No.	L	DCR (Ω)	SRF(Ref.)	Stauration Current	Heat Rating Current
	( uH )	(Max)	(MHz)	Isat (A)	Irms (A)
SPC 0810- 100M	10	0.040	22	8.0	3.5
SPC 0810- 150M	15	0.050	18	7.0	3.0
SPC 0810- 220M	22	0.066	11	5.5	2.5
SPC 0810- 330M	33	0.080	9.0	4.0	2.0
SPC 0810- 470M	47	0.11	8.0	3.8	1.6
SPC 0810- 680M	68	0.17	7.0	3.0	1.2
SPC 0810- 101M	100	0.22	5.0	2.5	1.2
SPC 0810- 151M	150	0.34	4.0	2.0	0.9
SPC 0810- 221M	220	0.44	3.5	1.6	0.7
SPC 0810- 331M	330	0.70	2.5	1.2	0.6
SPC 0810- 471M	470	0.95	2.0	1.0	0.3
SPC 0810- 681M	680	1.20	2.0	1.0	0.2
SPC 0810- 102M	1000	2.00	1.5	0.8	0.1

■ Notes:

- 1 . Test Freq. : 100KHz / 0.1V
- 2 . Operating temperaturer : -40 ~ 105 °C
- 3 . PACKAGING: SPC 0810 250Pcs/Reel